

CONEX-AG-GON-xP Series



PIEZO MOTOR GONIOMETRIC CRADLES WITH INTEGRATED CLOSED-LOOP CONTROLLER
CONNECT EASILY - CONTROL SIMPLY



For Motion, Think Newport™

- Highly repeatable angular motion with a direct read encoder
- High sensitivity (MIM) with Agilis™ Piezo Motor
- Orthogonal rotation about the same point when stacked
- Compact footprint and light weight
- Integrated controller and easy setup

The CONEX-AG-GON-xP Series is a high precision miniature goniometric cradle integrated with a closed-loop piezo motor controller/driver. AG-GON goniometric cradles feature an innovative miniature direct read encoder and provide ultra-high sensitivity with the Agilis™ piezo motor. AG-GON-UP and AG-GON-LP are designed so that orthogonal mounting of the two cradles provides two perpendicular axes of rotation about the same point in space for ultra-compact, tip and tilt.

The CONEX-AG-GON-xP features up to 7.5° travel range, 0.0006° repeatability and 0.0003° minimum incremental motion while maintaining a small footprint, making it ideal for ultra-sensitive alignments. Combined with the Agilis non-resonant piezo motor, the built-in direct read encoder ensures the tightest control of position and true set and forget, long term stability. With precision position feedback supplied by the highly repeatable encoder, backlash or hysteresis is close to zero.

The integrated CONEX-AGP is a very compact and inexpensive single axis motion controller with the same driver as the proven Agilis piezo motor driver. The controller is NSTRUCT compatible, with a simple and intuitive use and convenient access via USB, which also supplies power to the controller. Download NSTRUCT and the CONEX-AGP applet from newport.com.

Together with the CONEX-AG-LS25-27P linear stage and the CONEX-AG-PR100P rotation stage, the CONEX-AG-GON-xP series completes the offering of closed-loop piezo motor stage solutions of the CONEX-AGP series family. A vacuum compatible version is also available upon request.

Specifications

	CONEX-AG-GON-UP	CONEX-AG-GON-LP
Travel Range (°)	±7.5	±5.5
Minimum Incremental Motion, MIM (°)	0.00032	0.00025
Uni-directional repeatability (°)	0.00064	0.0005
Origin repeatability ⁽¹⁾ (°)	0.00064	0.0005
Maximum speed (°/s)	0.45	0.33
Weight [lb (kg)]	0.38 (0.171)	
Cz, Normal load capacity (N)	3.5	

⁽¹⁾ Origin is located at the negative limit.

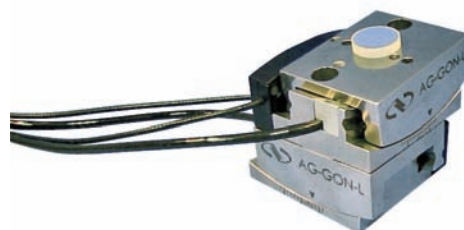

CONEX-AG-GON-P

Dimensions

AG-GON-LP

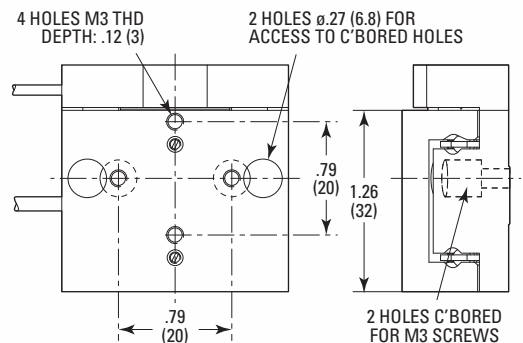

DIMENSIONS IN INCHES (AND MILLIMETERS)

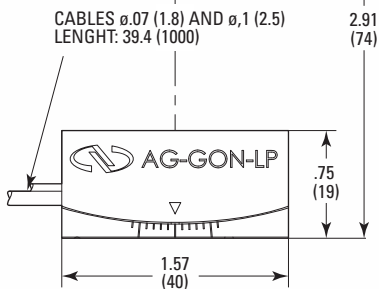

AG-GON-UP

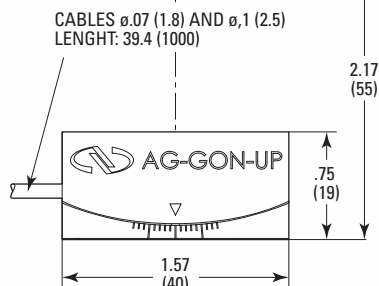
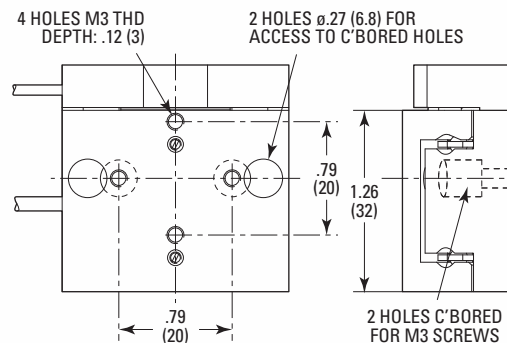

CONEX-AGP Controller

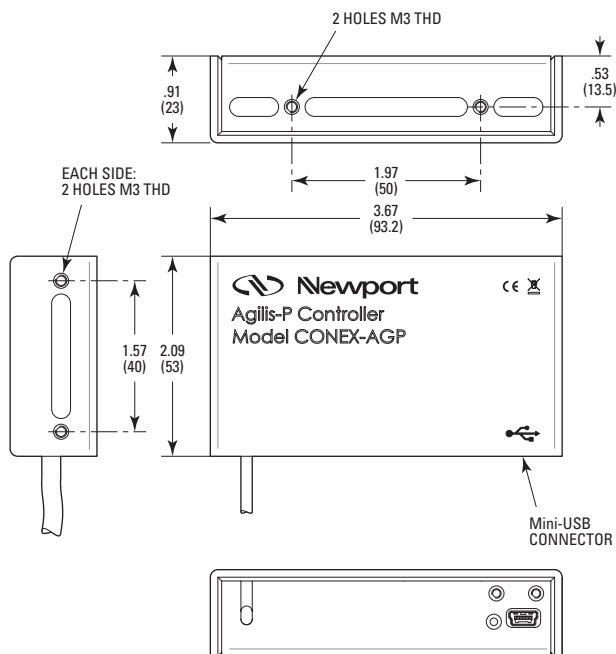

Download applet from
www.newport.com



Newport Corporation, Global Headquarters
1791 Deere Avenue, Irvine, CA 92606, USA

PHONE: 1-800-222-6440 1-949-863-3144 FAX: 1-949-253-1680 EMAIL: sales@newport.com
Complete listings for all global office locations are available online at www.newport.com/contact

www.newport.com

PHONE

Belgium +32-(0)0800-11 257
China +86-10-6267-0065
France +33-(0)1-60-91-68-68
Japan +81-3-3794-5511
Taiwan +886 -(0)2-2508-4977

EMAIL

belgium@newport.com
china@newport.com
france@newport.com
spectra-physics@splasers.co.jp
sales@newport.com.tw

PHONE

Irvine, CA, USA +1-800-222-6440
Netherlands +31-(0)30 6592111
United Kingdom +44-1235-432-710
Germany / Austria / Switzerland +49-(0)6151-708-0

EMAIL

sales@newport.com
netherlands@newport.com
uk@newport.com
germany@newport.com

Newport Corporation, Irvine, California and Franklin, Massachusetts; Evry and Beaune-La-Rolande, France and Wuxi, China have all been certified compliant with ISO 9001 by the British Standards Institution. Santa Clara, California is DNV certified.

Newport. Family of Brands – ILX Lightwave® • New Focus™ • Ophir® • Oriol® Instruments • Richardson Gratings™ • Spectra-Physics® • Spiricon®